

Courses and Distances  
on Creek Beginning at  
The Elm thence Down to

- S 48 W 43
- S 41 W 48 1/2
- S 46 E 52 1/2
- S 86 E 36
- N 79 E 41

S 70 E 46 1/2 to the Ash  
267 1/2

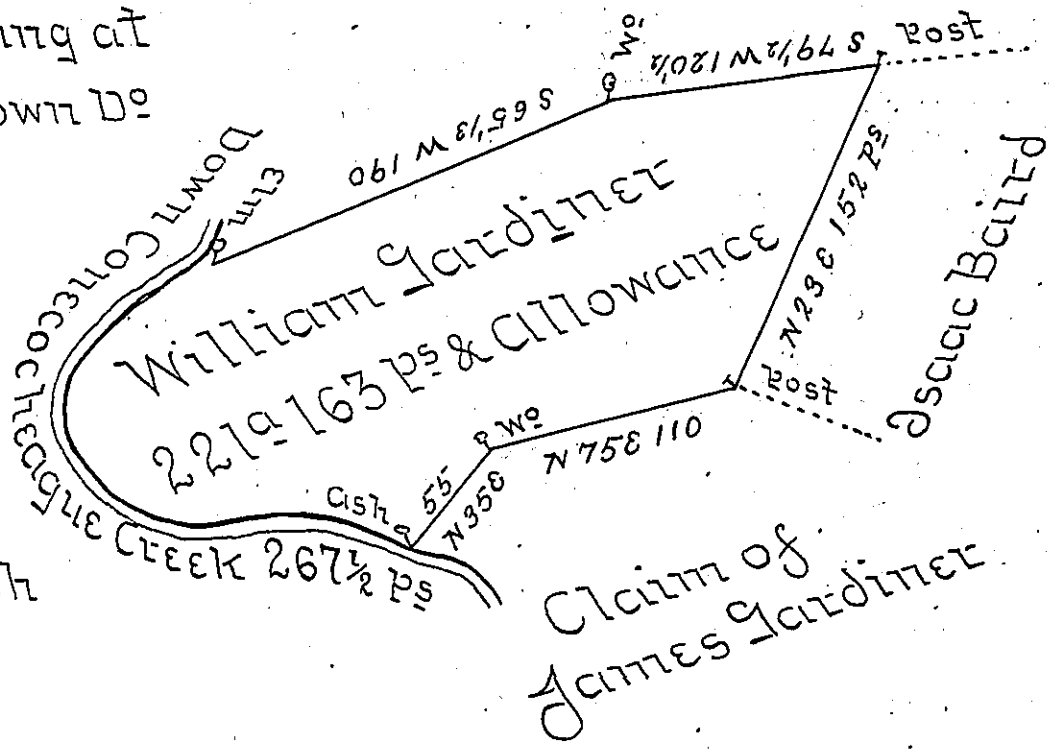

A Draft of a Tract of Land Situate (formerly in the Township of Hopewell in the County of Lancaster) now in Peters Township in the County of Franklin containing two hundred and twenty one Acres and 163 perches and the Allowance of six Percent for Roads &c Resurveyed agreeable to a Draft signed George Stevenson said thereon to be a true Copy taken from a Draft found among the papers of Thomas Cookson Esq (the 25<sup>th</sup> of April 1796 in pursuance of directions from the Surveyor General on an Order of the Hon<sup>ble</sup> the Board of Property granted the 07<sup>th</sup> February 1796 to the Petition of W<sup>m</sup> McMillan Gardiner, who Claims the Land by Virtue of a Warrant granted to William Gardiner bearing Date the 11<sup>th</sup> February 1742 - which Tract or the greater part is said to be Claimed by the Heirs of a certain Samuel Gettis late of York County. To Daniel Brodhead Esquire - ) Dan<sup>l</sup> Henderson U.S. Surveyor General of Pennsylvania.)

IN TESTIMONY that the above is a copy of the original remaining on file in the Department of Internal Affairs of Pennsylvania, made conformably to an Act of Assembly approved the 16th day of February, 1833, I have hereunto set my Hand and caused the Seal of said Department to be affixed at Harrisburg, this eighteenth day of January 1905.

*James D. Hanson*  
Secretary of Internal Affairs.